



**PARAMOUNT**  
REALTY

# FORMER CVS/PHARMACY

165 SOUTH RICHLAND AVENUE, YORK, PA 17404

York County | GLA: ± 10,158 SF



- 10,158 SF CVS/Pharmacy located at the intersection of West Princess Street & South Richland Avenue with combined traffic counts exceeding 19,900 vehicles per day
- Situated near dense residential community, schools and businesses

DEMOGRAPHICS	<u>1 Mile</u>	<u>3 Mile</u>	<u>5 Mile</u>
<b>Population:</b>	24,718	85,833	153,715
<b>Avg. HH Income:</b>	\$79,925	\$85,068	\$99,265
<b>Households:</b>	8,950	33,394	60,910

ARLENE GRAY [agray@paramountrealty.com](mailto:agray@paramountrealty.com)  
KRISTI PENNINGTON [kpennington@paramountrealty.com](mailto:kpennington@paramountrealty.com)

120 North Pointe Blvd., Suite 301, Lancaster, PA 17601  
717-569-9373 | [paramountrealty.com](http://paramountrealty.com)



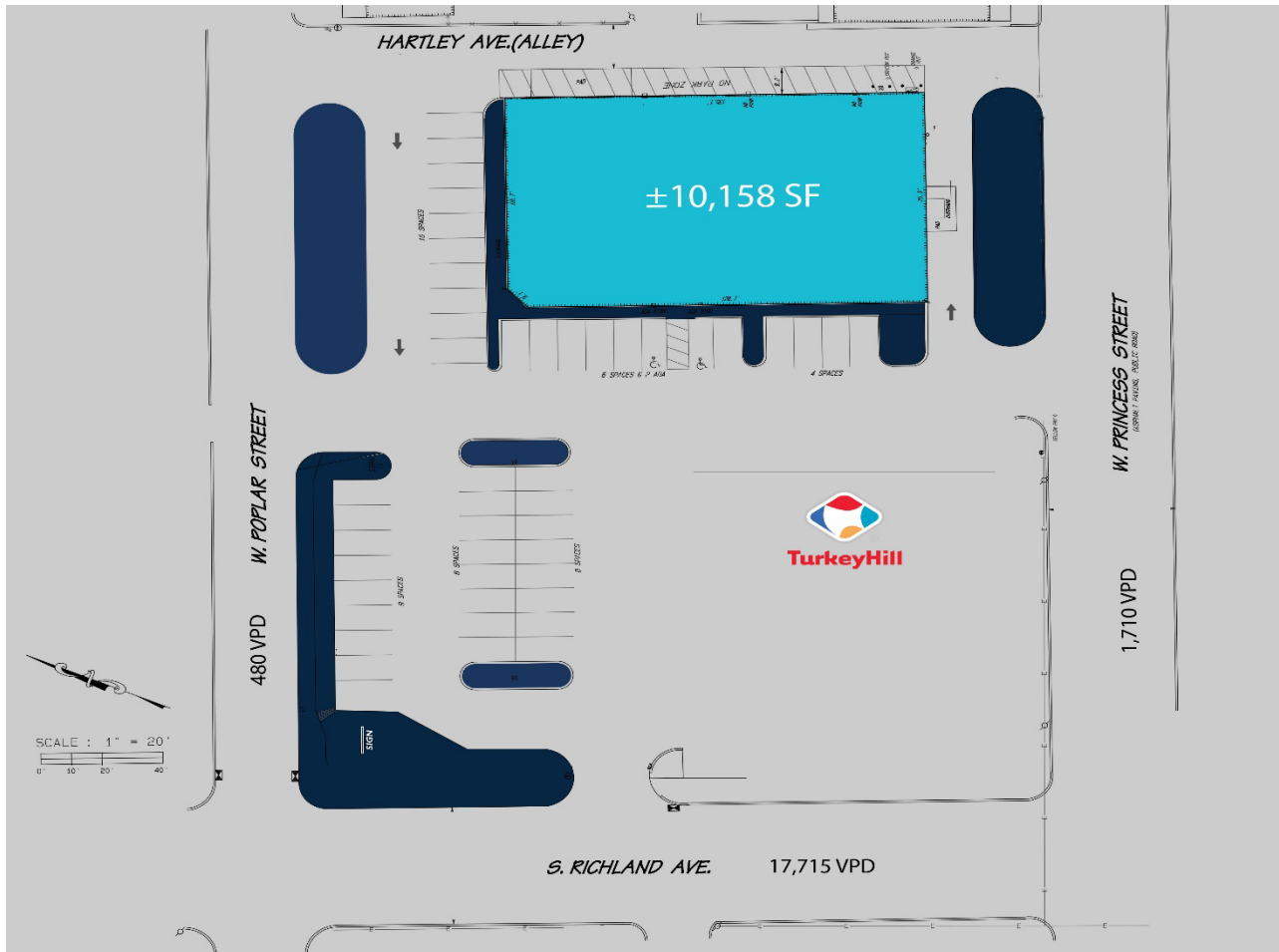

FORMER CVS/PHARMACY  
100% LEASED

Subject To Change

1 AVAILABLE

10,158 SF



The information herein (including all faxes pertaining to the same) has been obtained from sources deemed reliable. While we do not doubt its accuracy, we have not verified and make no guarantee, warranty, or representation about it. It is your responsibility to independently confirm its accuracy and completeness and is subject to correction or can be withdrawn without notice.



ARLENE GRAY [agray@paramountrealty.com](mailto:agray@paramountrealty.com)  
KRISTI PENNINGTON [kpennington@paramountrealty.com](mailto:kpennington@paramountrealty.com)

120 North Pointe Blvd., Suite 301, Lancaster, PA 17601  
717-569-9373 | [paramountrealty.com](http://paramountrealty.com)





**PARAMOUNT**  
REALTY

**FORMER CVS/PHARMACY**

165 SOUTH RICHLAND AVENUE, YORK, PA 17404



ARLENE GRAY [agray@paramountrealty.com](mailto:agray@paramountrealty.com)  
KRISTI PENNINGTON [kpennington@paramountrealty.com](mailto:kpennington@paramountrealty.com)

120 North Pointe Blvd., Suite 301, Lancaster, PA 17601  
717-569-9373 | [paramountrealty.com](http://paramountrealty.com)