



**PARAMOUNT**  
REALTY

# OFFICE / TECHNICAL BUILDING

3050 HEMPLAND ROAD, LANCASTER, PA 17601

Lancaster County | GLA: ± 53,207 SF



- One story professional office building
- Former tech school with 20+ offices & 30 instruction rooms
- Excellent visibility and access from Route 30 via Centerville Road exit
- ± 303 parking spaces

DEMOGRAPHICS	<u>1 Mile</u>	<u>3 Mile</u>	<u>5 Mile</u>
<b>Population:</b>	5,471	45,898	125,102
<b>Avg. HH Income:</b>	\$86,161	\$92,293	\$86,754
<b>Households:</b>	2,102	18,576	49,340

ARLENE GRAY [agray@paramountrealty.com](mailto:agray@paramountrealty.com)  
KRISTI PENNINGTON [kpennington@paramountrealty.com](mailto:kpennington@paramountrealty.com)

120 North Pointe Blvd., Suite 301, Lancaster, PA 17601  
717-569-9373 | [paramountrealty.com](http://paramountrealty.com)



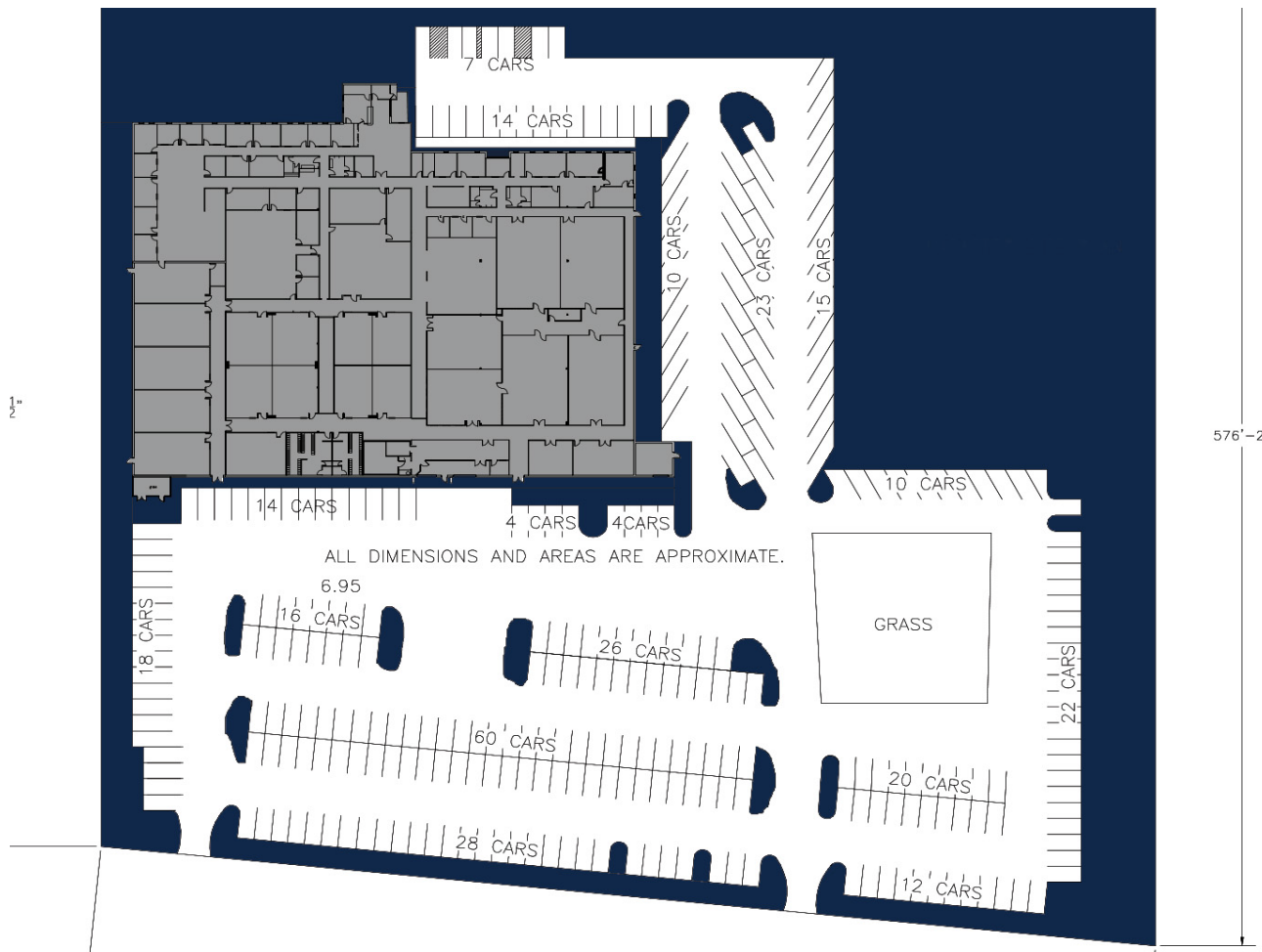

The information herein (including all faxes pertaining to the same) has been obtained from sources deemed reliable. While we do not doubt its accuracy, we have not verified and make no guarantee, warranty, or representation about it. It is your responsibility to independently confirm its accuracy and completeness and is subject to correction or can be withdrawn without notice.

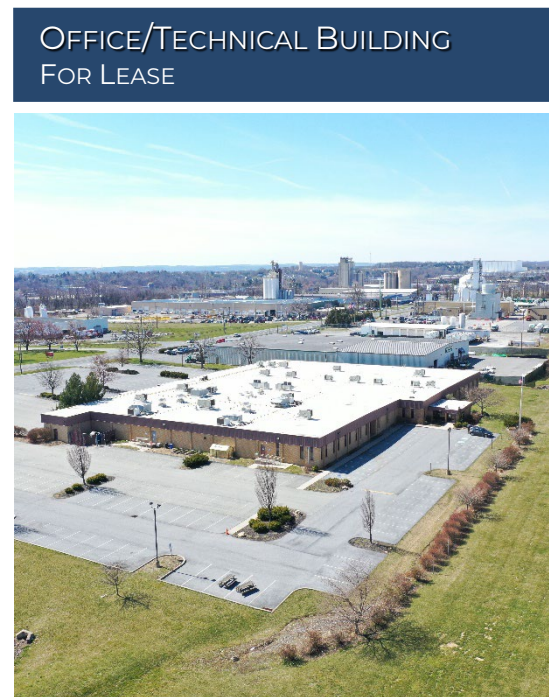





**PARAMOUNT**  
REALTY

**OFFICE / TECHNICAL BUILDING**  
3050 HEMPLAND ROAD, LANCASTER, PA 17601

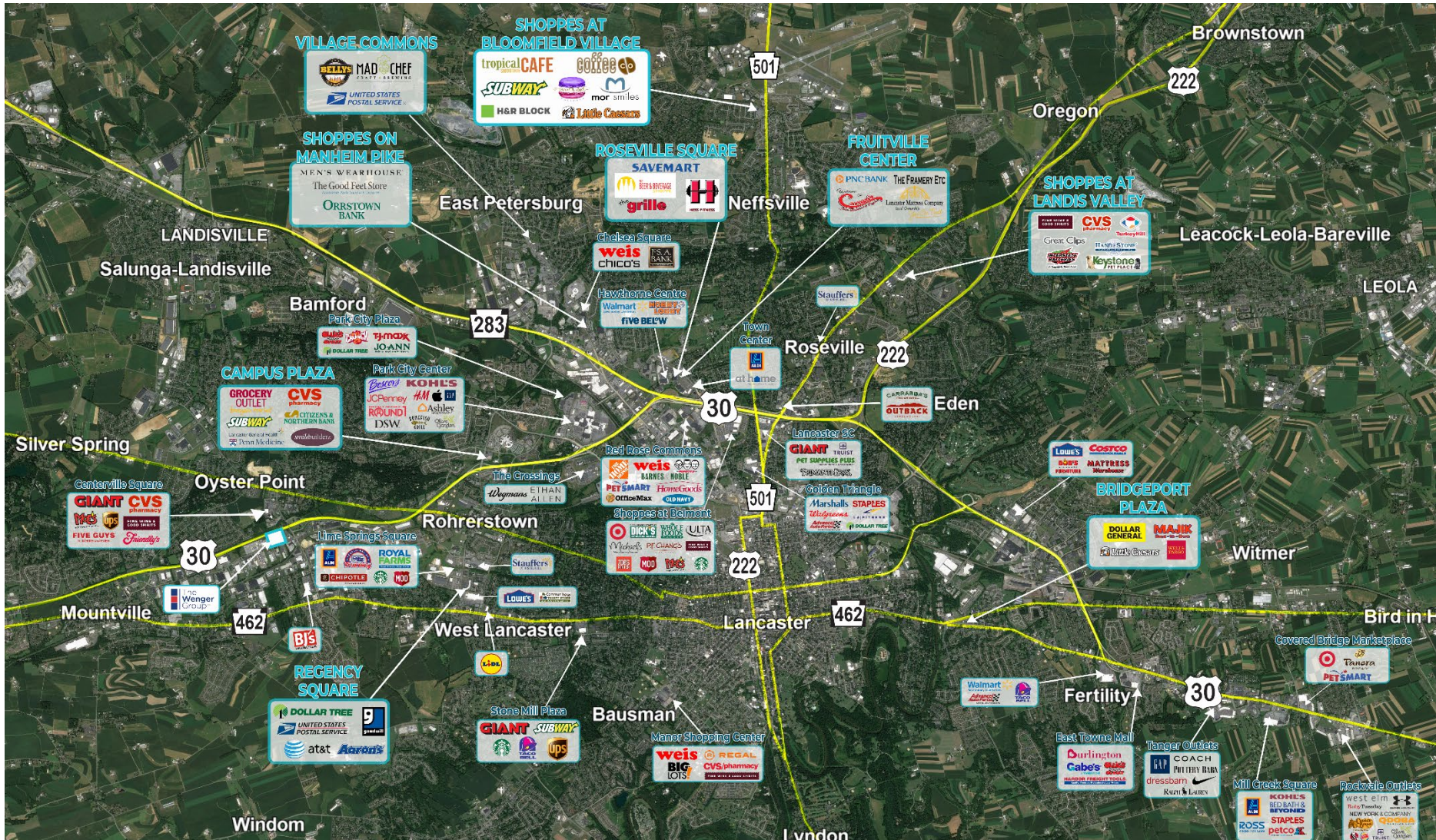

ARLENE GRAY [agray@paramountrealty.com](mailto:agray@paramountrealty.com)  
KRISTI PENNINGTON [kpennington@paramountrealty.com](mailto:kpennington@paramountrealty.com)

120 North Pointe Blvd., Suite 301, Lancaster, PA 17601  
717-569-9373 | [paramountrealty.com](http://paramountrealty.com)